

## TO-92L Plastic-Encapsulate Transistors

### 2SC2060 TRANSISTOR (NPN)

#### FEATURE

- Power Dissipation  $P_{CM}$ : 0.75 W ( $T_a=25^\circ\text{C}$ )
- Low Saturation Voltage ( $V_{CE(sat)}=0.15\text{V}$  at 500mA)
- Complementary Pair with 2SA934

#### TO-92L

1. EMITTER
2. COLLECTOR
3. BASE

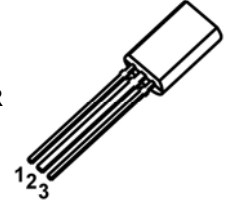

#### MAXIMUM RATINGS ( $T_a=25^\circ\text{C}$ unless otherwise noted)

Symbol	Parameter	Value	Unit
$V_{CBO}$	Collector-base voltage	40	V
$V_{CEO}$	Collector-Emitter Voltage	32	V
$V_{EBO}$	Emitter-Base Voltage	5	V
$I_C$	Collector Current -Continuous	1	A
$P_C$	Collector Power Dissipation	750	mW
$T_J$	Junction Temperature	150	$^\circ\text{C}$
$T_{stg}$	Storage Temperature	-55-150	$^\circ\text{C}$

#### ELECTRICAL CHARACTERISTICS ( $T_a=25^\circ\text{C}$ unless otherwise specified)

Parameter	Symbol	Test conditions	Min	Max	Unit
Collector-base breakdown voltage	$V(BR)_{CBO}$	$I_C=100\mu\text{A}$ , $I_E=0$	40		V
Collector-emitter breakdown voltage	$V(BR)_{CEO}$	$I_C=1\text{mA}$ , $I_B=0$	32		V
Emitter-base breakdown voltage	$V(BR)_{EBO}$	$I_E=100\mu\text{A}$ , $I_C=0$	5		V
Collector cut-off current	$I_{CBO}$	$V_{CB}=20\text{V}$ , $I_E=0$		0.5	$\mu\text{A}$
Emitter cut-off current	$I_{EBO}$	$V_{EB}=4\text{V}$ , $I_C=0$		0.1	$\mu\text{A}$
DC current gain	$h_{FE}$	$V_{CE}=3\text{V}$ , $I_C=100\text{mA}$	80	400	
Collector-emitter saturation voltage	$V_{CE(sat)}$	$I_C=500\text{mA}$ , $I_B=50\text{mA}$		0.4	V
Transition frequency	$f_T$	$V_{CE}=5\text{V}$ , $I_E=-50\text{mA}$	50		MHz
Collector output capacitance	$C_{ob}$	$V_{CB}=10\text{V}$ , $I_E=0$ , $f=1\text{MHz}$		30	pF

## TO-92L Package Outline Dimensions

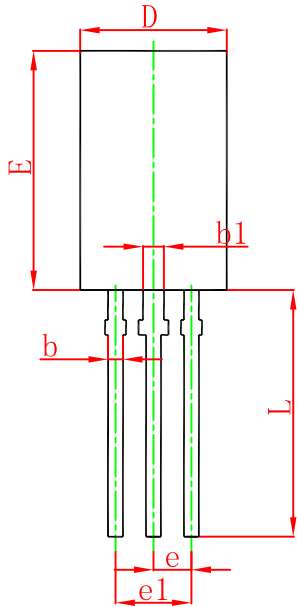
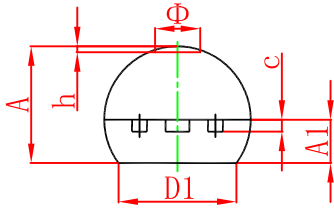

Symbol	Dimensions In Millimeters		Dimensions In Inches	
	Min.	Max.	Min.	Max.
A	3.750	4.050	0.148	0.159
A1	1.280	1.580	0.050	0.062
b	0.380	0.550	0.015	0.022
b1	0.620	0.780	0.024	0.031
c	0.350	0.450	0.014	0.018
D	4.750	5.050	0.187	0.199
D1	4.000		0.157	
E	7.850	8.150	0.309	0.321
e	1.270 TYP.		0.050 TYP.	
e1	2.440	2.640	0.096	0.104
L	13.800	14.200	0.543	0.559
$\Phi$		1.600		0.063
h	0.000	0.300	0.000	0.012

## TO-92L Suggested Pad Layout

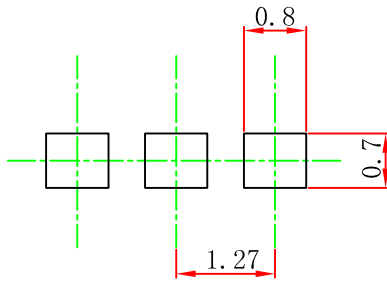

### Note:

1. Controlling dimension: in millimeters.
2. General tolerance:  $\pm 0.05$ mm.
3. The pad layout is for reference purposes only.

### NOTICE

JCET reserve the right to make modifications, enhancements, improvements, corrections or other changes without further notice to any product herein. JCET does not assume any liability arising out of the application or use of any product described herein.

# TO-92L PACKAGE TAPEING DIMENSION

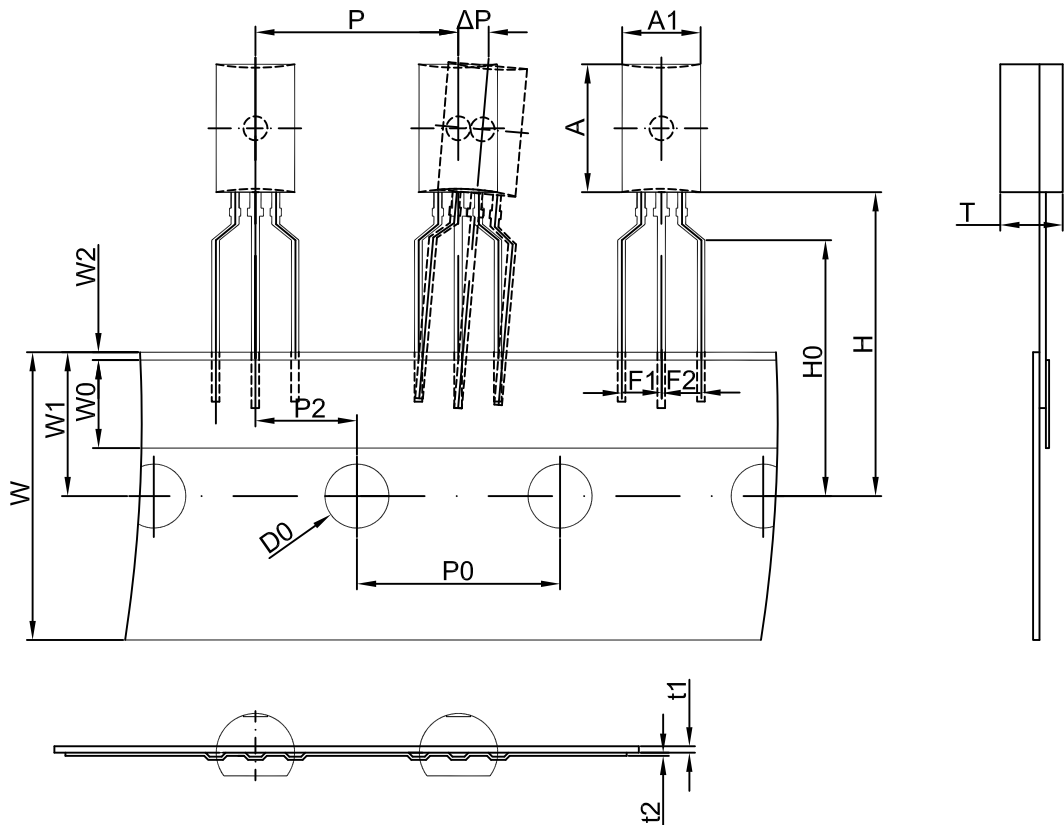

Dimensions are in millimeter

A1	A	T	P	P0	P2	F1	F2	W
4.9	8.0	3.9	12.7	12.7	6.35	2.5	2.5	18.0
W0	W1	W2	H	H0	D0	t1	t2	ΔP
6.0	9.0	1.0	19.0	16.0	4.0	0.4	0.2	0

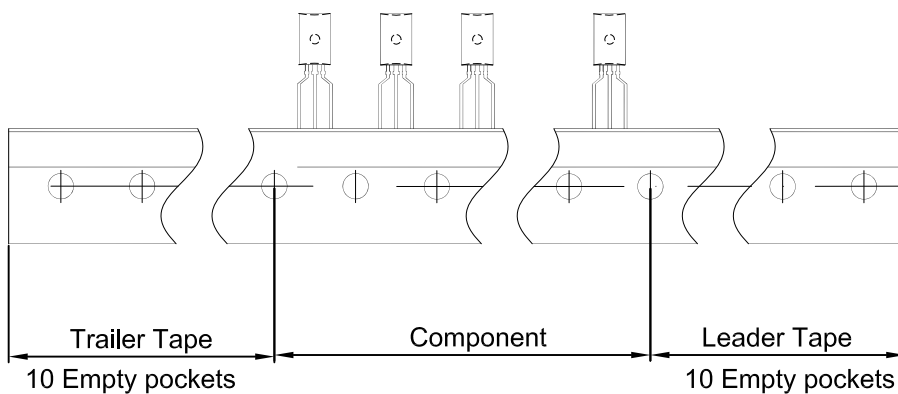

Package	Box	Box Size(mm)	Carton	Carton Size(mm)
TO-92L	2000 pcs	333×203×42	20,000 pcs	493×400×264